



**67 BRIDGE ROAD
CHESSINGTON
KT9 2RX
£325,000**

FIRST FLOOR MAISONETTE

TWO DOUBLE BEDROOMS

17'10 X 13'2 LIVING ROOM

10' X 8'9 KITCHEN

WHITE BATHROOM SUITE

DOUBLE GLAZED WINDOWS

GAS CENTRAL HEATING

39' X 35' REAR GARDEN

TWO BRICK BUILT STORAGE SHEDS

AN IDEAL FIRST TIME BUY

1st Floor Flat
75.0 sq.m. (807 sq.ft.) approx.

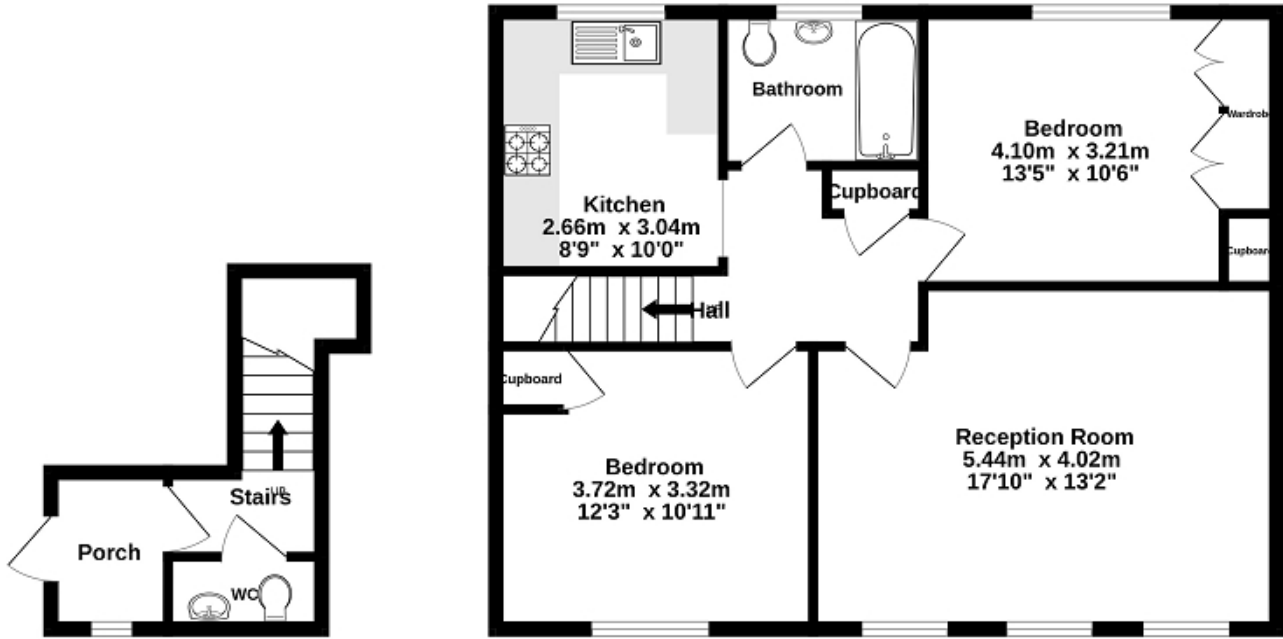

TOTAL FLOOR AREA : 75.0 sq.m. (807 sq.ft.) approx.

Whilst every attempt has been made to ensure the accuracy of the floorplan contained here, measurements of doors, windows, rooms and any other items are approximate and no responsibility is taken for any error, omission or mis-statement. This plan is for illustrative purposes only and should be used as such by any prospective purchaser. The services, systems and appliances shown have not been tested and no guarantee as to their operability or efficiency can be given.
Made with Metropix ©2026



Energy Efficiency Rating

	Current	Potential
Very energy efficient - lower running costs		
(92+) A		
(81-91) B		
(69-80) C	74	75
(55-68) D		
(39-54) E		
(21-38) F		
(1-20) G		
Not energy efficient - higher running costs		
England, Scotland & Wales EU Directive 2002/91/EC		

The energy efficiency rating is a measure of the overall efficiency of a home. The higher the rating the more energy efficient the home is and the lower the fuel bills will be.