



**7 MAY CLOSE
CHESSINGTON
SURREY
KT9 2AP
OFFERS IN EXCESS OF
£300,000**

SPLIT LEVEL MAISONETTE

TWO BEDROOMS

14'10 X 12'9 LIVING ROOM

10'8 X 6'8 MODERN KITCHEN

WHITE BATHROOM SUITE

DOUBLE GLAZED WINDOWS

GAS CENTRAL HEATING

OWN REAR GARDEN

LEASE IN EXCESS OF 900 YEARS

CUL DE SAC LOCATION

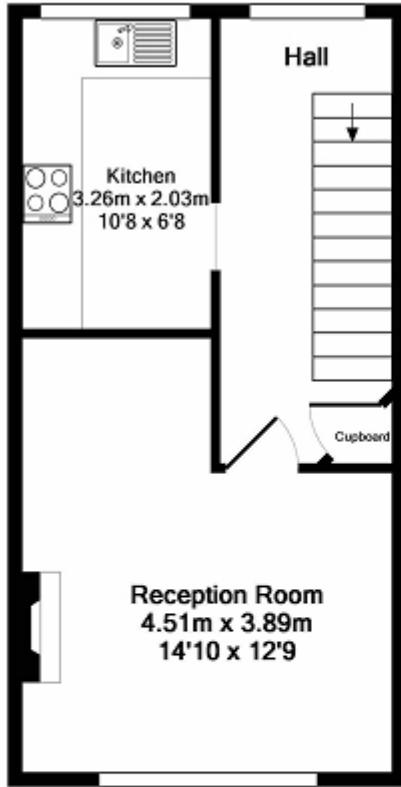

Lower Floor
Approx. Floor
Area 30.2 Sq.M.
(325 Sq.Ft.)

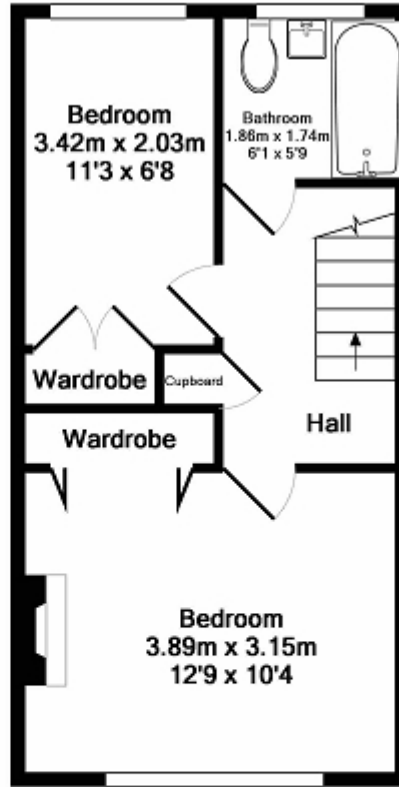

Upper Floor
Approx. Floor
Area 30.2 Sq.M.
(325 Sq.Ft.)

Total Approx. Floor Area 60.5 Sq.M. (651 Sq.Ft.)

Whilst every attempt has been made to ensure the accuracy of the floor plan contained here, measurements of doors, windows, rooms and any other items are approximate and no responsibility is taken for any error, omission, or mis-statement. This plan is for illustrative purposes only and should be used as such by any prospective purchaser. The services, systems and appliances shown have not been tested and no guarantee as to their operability or efficiency can be given

Made with Metropix ©2018



Energy Efficiency Rating		
	Current	Potential
<i>Very energy efficient - lower running costs</i>		
(92+) A		
(81-91) B		
(69-80) C		74
(55-68) D		
(39-54) E	48	
(21-38) F		
(1-20) G		
<i>Not energy efficient - higher running costs</i>		
England, Scotland & Wales	EU Directive 2002/91/EC	

The energy efficiency rating is a measure of the overall efficiency of a home. The higher the rating the more energy efficient the home is and the lower the fuel bills will be.