



**24 MOUNT ROAD
CHESSINGTON
SURREY
KT9 1JG
£435,000**

EXTENDED TERRACED HOUSE

TWO BEDROOMS

12'3 X 10'11 LIVING ROOM

14'1 X 8' DINING AREA

MODERN KITCHEN AND BATHROOM

DOUBLE GLAZED WINDOWS

GAS CENTRAL HEATING

100' SOUTH EASTERLY GARDEN

35' GARAGE AND OFF STREET PARKING

WELL PRESENTED

Ground Floor
34.4 sq.m. (370 sq.ft.) approx.

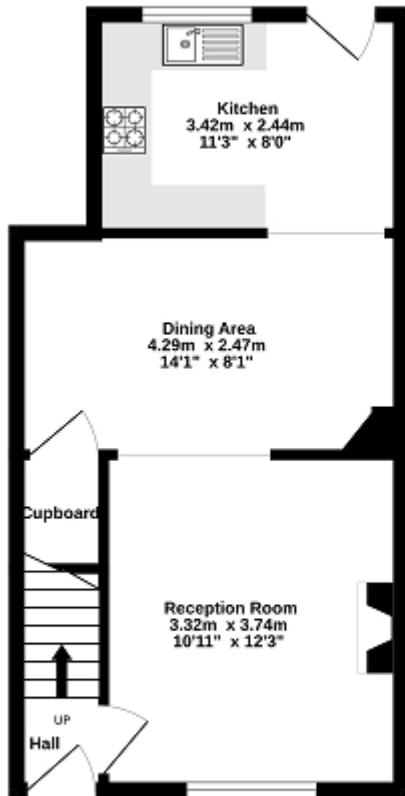

1st Floor
27.0 sq.m. (291 sq.ft.) approx.

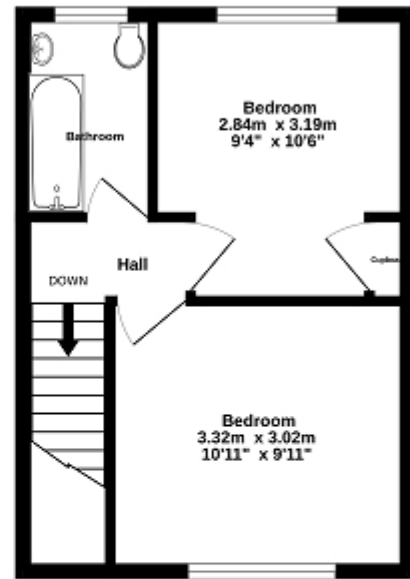

TOTAL FLOOR AREA: 61.4 sq.m. (660 sq.ft.) approx.

While every attempt has been made to ensure the accuracy of the footprint contained here, measurements of floors, windows, doors and any other items are approximate and no responsibility is taken for any error, omission or mis-statement. This plan is for illustrative purposes only and should be used as such by any prospective purchaser. The services, systems and appliances shown have not been tested and no guarantee as to their operability or efficiency can be given.
Made with Metropix 02024



Energy Efficiency Rating		
	Current	Potential
Very energy efficient - lower running costs		
(92+) A		
(81-91) B		85
(69-80) C		
(55-68) D	66	
(39-54) E		
(21-38) F		
(1-20) G		
Not energy efficient - higher running costs		
England, Scotland & Wales	EU Directive 2002/91/EC	

The energy efficiency rating is a measure of the overall efficiency of a home. The higher the rating the more energy efficient the home is and the lower the fuel bills will be.