



**28 DRAKE ROAD
CHESSINGTON
SURREY
KT9 1LW
OFFERS IN EXCESS OF
£425,000**

TERRACED HOUSE

THREE BEDROOMS

17'5 X 15'3 LIVING ROOM

9'11 X 9'1 MODERN KITCHEN

MODERN BATHROOM SUITE

DOUBLE GLAZED WINDOWS

GAS CENTRAL HEATING

30' SOUTH EASTERLY FACING GARDEN

GARAGE IN BLOCK

VIEWINGS HIGHLY RECOMMENDED

Ground floor
39.3 sq.m. (423 sq.ft.) approx.

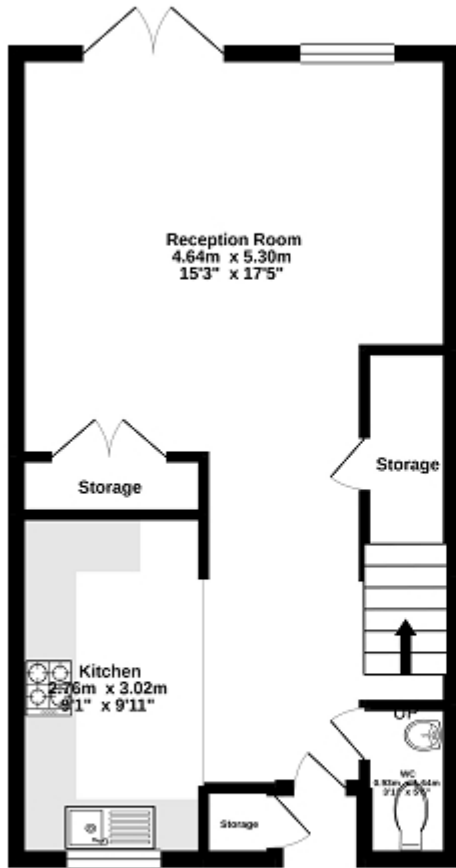

1st floor
40.0 sq.m. (430 sq.ft.) approx.

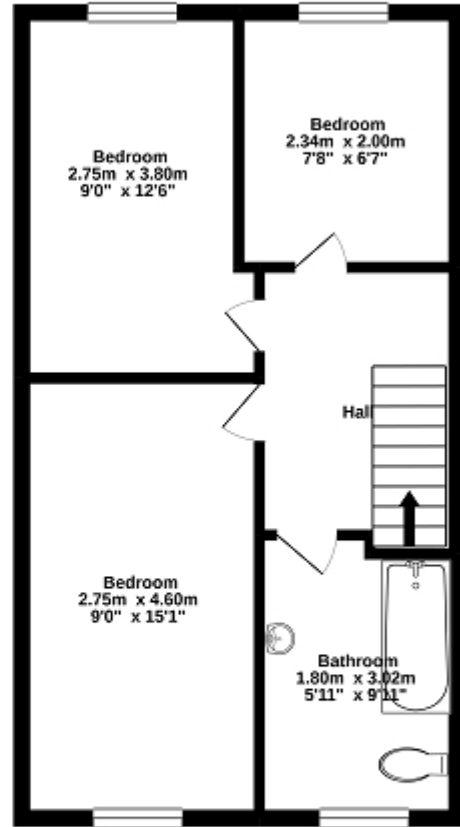

TOTAL FLOOR AREA: 79.0 sq.m. (840 sq.ft.) approx.

Whilst every attempt has been made to ensure the accuracy of the floorplan contained here, measurements of doors, windows, rooms and any other items are approximate and no responsibility is taken for any error, omission or mis-statement. This plan is for illustrative purposes only and should be used as such by any prospective purchaser. The services, systems and appliances shown have not been tested and no guarantee as to their operability or efficiency can be given.
Made with Metagrip ©2020



Energy Efficiency Rating

	Current	Potential
Very energy efficient - lower running costs		
(92+) A		
(81-91) B		88
(69-80) C	74	
(55-68) D		
(39-54) E		
(21-38) F		
(1-20) G		
Not energy efficient - higher running costs		
England, Scotland & Wales	EU Directive 2002/91/EC	

The energy efficiency rating is a measure of the overall efficiency of a home. The higher the rating the more energy efficient the home is and the lower the fuel bills will be.