



**2 ORCHARD GARDENS
CHESSINGTON
SURREY
KT9 1AG
£600,000**

EXTENDED SEMI DETACHED HOUSE

THREE BEDROOMS

TWO RECEPTION ROOMS

CONSERVATORY

DOUBLE GLAZED WINDOWS

GAS CENTRAL HEATING

REAR & SIDE GARDENS

GARAGE WITH OWN DRIVEWAY

POTENTIAL TO EXTEND S.T.P.P

AN IDEAL FAMILY HOME



Ground Floor with Plot
331.0 sq.m. (3571 sq.ft.) approx.

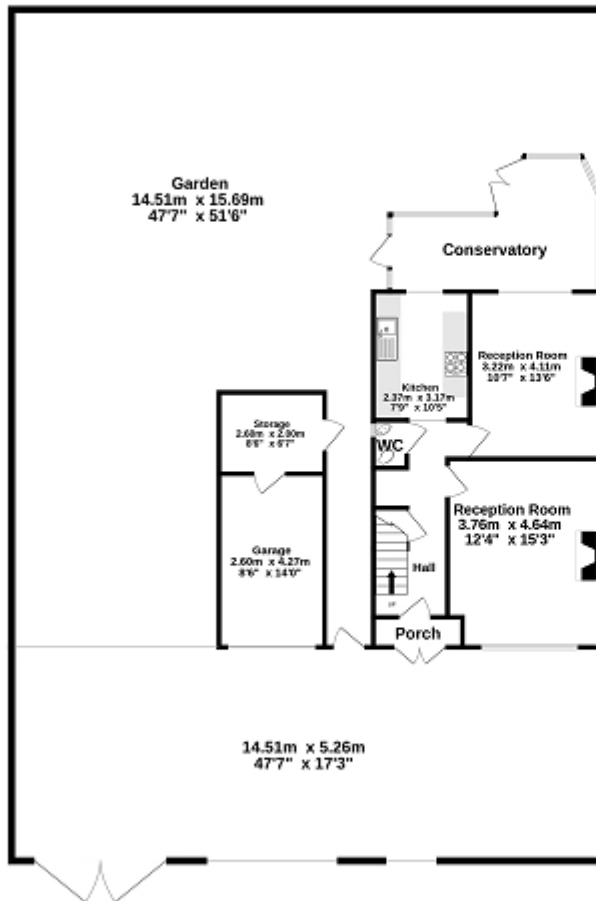

1st Floor
44.0 sq.m. (462 sq.ft.) approx.

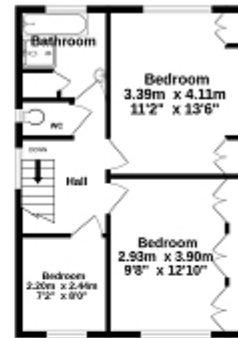

TOTAL FLOOR AREA: 375.0 sq.m. (4035 sq.ft.) approx.

While every effort has been made to ensure the accuracy of the floorplan contained herein, measurements of doors, windows, rooms and any other items are approximate and no responsibility is taken for any error, omission or mis-statement. This plan is for illustrative purposes only and should be used as such by any prospective purchaser. The services, systems and appliances shown here and herein beyond and no guarantee as to their operability or efficiency can be given.
Made with Hozspot 6/2022



Energy Efficiency Rating

	Current	Potential
Very energy efficient - lower running costs		
(92+) A		
(81-91) B		81
(69-80) C		
(55-68) D	64	
(39-54) E		
(21-38) F		
(1-20) G		
Not energy efficient - higher running costs		
England, Scotland & Wales	EU Directive 2002/91/EC	

The energy efficiency rating is a measure of the overall efficiency of a home. The higher the rating the more energy efficient the home is and the lower the fuel bills will be.